

## PRODUCT SPECIFICATIONS & INSTALLATION INFORMATION

01-290-200 Vent Cover (Solid Plate - 19" x 10")

01-290-400 Vent Cover (Solid Plate - 22" x 10")

### Specifications:

Mounting: Plate mounts from inside crawlspace behind existing vent opening.



### Tools needed for Installation:

- Drill(s) (Note: Two drills will avoid the need to switch drill bits while in the crawlspace).
- Masonry screw kit (i.e. masonry screws and drill bit for concrete/masonry)
- Drill bit for screws selected

### Installation Steps:

1. Plate will be mounted to wall from inside the crawlspace. Align the plate to cover the opening.
2. Permanently secure to the wall with 2 to 4 screws. Drill into the top corner of the plate through plastic and into wall using masonry drill bit. (Note: If mounting to brick, it is best to drill into mortar between the brick. If mounting to cinder block, you can drill into mortar or directly into cinder block.)
3. Hold the plate in place and then insert masonry screw and tighten the screw with drill.
4. Repeat steps for drilling, inserting screws and tightening.

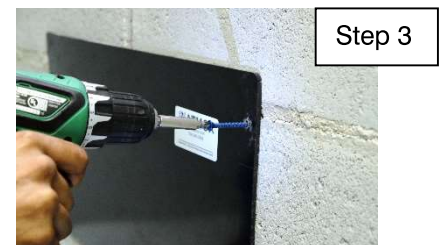

### ATMOX INC

10612-D Providence Road #229  
Charlotte, NC 28277

Phone: 704.248.2858  
Fax: 704.675.9858

Website: [www.atmox.com](http://www.atmox.com)  
Email: [info@atmox.com](mailto:info@atmox.com)